



GREENCASTLE-ANTRIM HIGH SCHOOL
300 SOUTH RIDGE AVENUE
GREENCASTLE, PA 17225
January 29, 2020

Dear Director:

We are finalizing plans for our 33rd Annual GA Indoor Show. You will find a copy of the performance schedule along with important show information and directions to the school enclosed. Our show will be starting at 4:00 PM on Saturday, January 29th. Housing and Dressing facilities will be located in the high school while warm-up facilities will be available in the middle school. **** OUR SCHOOL HEALTH AND SAFETY PLAN STATES, MASKING IS SUGGESTED; HOWEVER, IT IS AT THE DISCRETION OF THE INDIVIDUAL. We do highly recommend masking while in the gym, as we do have a small gym, but again it is at your discretion.** If there are any questions, please feel free to contact our show coordinator, Brock Bricker, contact info located below. We look forward to seeing all of you the day of our show.

TIMELINE FOR THE DAY: **2:30 PM – DOORS WILL OPEN FOR PERFORMERS** *(If you need to arrive prior to 2:30PM that is not a problem, just please let us know.)*

3:00 PM – CONCESSION STAND WILL OPEN ALONG WITH THE DOORS FOR SPECTATORS

4:00 PM – THE SHOW WILL START WITH PERCUSSION UNITS

4:36 PM – PERCUSSION AWARDS

4:45 PM – SOUND CHECK (following percussion awards)

5:45 PM – GUARDS START

7:45 PM – GUARD AWARDS

ADMISSION: Adults - \$10.00 Students/Sr. Citizens - \$5.00 Programs – \$2.00

RULES AND JUDGES: Keystone Indoor Drill Association (K.I.D.A).

PARKING: Buses should enter by way of the middle school entrance (entrance closest to Leitersburg Rd.). continue past the Middle School and Drop off your students at the 1st entrance to the high school (first set of double doors). Bus parking will be in front of both the high school and middle school. There will be parent volunteers to help guide getting your busses parked. All equipment will be unloaded in front of the Middle School. Your equipment vehicle will then move to that area outside of the south gym doors. We ask that you try and pack up your equipment as fast as possible so that other groups can use the area. There will be spectator parking in the rear of the high school right by the gym entrance. **(See enclosed map).**

CHECK-IN/HOUSING AREA/DRESSING ROOMS: Check-in will be located in the auditorium lobby at the high school. Upon check-in you will receive your unit's information packet that will provide you with everything needed for the day. Wrist bands for your students will be included along with 10 wrist bands (per KIDA Policy) for staff and chaperones. Any staff or parent chaperones over 10 will have to pay. **We will have a money box and extra wrist bands for purchase at the check in table for those groups needing more than 10 staff/chaperone wrist bands. No one will be permitted to enter the gym without a wrist band.** All groups will be housed in the high school auditorium with bathrooms available near the auditorium for changing. One set of bathrooms are right at the auditorium entrance and the other set will be right down the hall across from the auditorium. **Please remind your students that the auditorium is for housing purposes only and is not intended to be used for dressing rooms. Dressing will be available only in bathrooms. There will be no food or drinks permitted in the auditorium. Additionally, the Greencastle-Antrim School District is an alcohol/drug free and non-smoking school campus. All groups will be responsible for their own equipment and belongings during the show.**

EQUIPMENT UNLOADING AND STORAGE: *All equipment will be unloaded at the middle school.*

Props and other guard equipment will be stored in a hallway at the middle school or outside in the underpass connecting the two schools. ***Due to the lack of storage space at the high school, units will only be able to store floor mat carts in the hallway alongside the high school cafeteria.*** Please ***DO NOT*** stack props and things on top of the mats since there is a limited amount of space available. Equipment storage is very important to follow so there is not any undue stress on you or your kids the day of the show. Please ask if you have any questions where your equipment should go.

PERCUSSION WARM-UP AREAS: This year the assigned areas are the middle school gym, middle school cafeteria, and the middle school band room. The gym and the cafeteria will be divided into 2 allowing groups to set-up as another group is finishing their warm-up. This will allow for ALL groups to use their time for warm-up and not have to include tear down and set-up as part of their warm-up. ***WE ASK THAT YOU PLEASE KEEP YOUR STUDENTS QUIET WHILE YOU SET-UP. YOU WOULD NOT WANT ANOTHER GROUP TALKING WHILE YOU ARE WARMING-UP SO, PLEASE RETURN THE SAME COURTESY.*** Percussion units will be given a 20-minute warm-up time in one of these 3 assigned areas, or you can find an area outside the building if weather permits for more warm-up time. A host in the middle school will assist you with finding the appropriate area. Please be at the high school gym about 9 minutes before your performance time. You can find your warm-up area in the attached schedule. If you are the group setting up or tearing down while the group on the other side of the space is warming up please be respectful. ***Please make sure that all equipment is well padded and won't harm the gym floor. Each group is responsible for any damage to the host floor as per K.I.D.A. rules. Also remind your students that they will need to wear shoes since they will travel between buildings from the warm-up area to the performance area.***

COLOR GUARD WARM-UP AREAS: The color guard units will be warming-up in the middle school cafeteria and gym (partitioned into 2 sections). Each unit will receive either 19 or 22 minute blocks of time in their given area for body and equipment warm-up. How you utilize the time is up to your unit. ***Please remind your students that they will need to wear shoes since they will travel across the parking lot to the warm-up area and then to the performance area.*** Please be at the gym about 7 to 8 minutes before your performance time (depending upon your show interval) in order to keep the show moving. Also advise the members of your group that there will be no spinning or twirling of equipment in the hallways or dressing rooms. ***Please make sure that all equipment is well padded and won't harm the gym floor. Each group is responsible for any damage to the host floor as per KIDA rules.***

JUDGES ROOM: The judges' meeting will take place in one of the high school Tech-Ed rooms at the conclusion of each part of the show. This room will be right across from the HS band room.

STAFF/JUDGES HOSPITALITY AREA: We invite the judges and staff to join us in our hospitality area this year. The hospitality area will be located right across from the judge's room in the high school band room, this way you will have a nice place to sit while you are waiting to go in and speak with the judges. We will have food and drinks available for both staff and judges. We ask that while you are here you keep social distanced. We will keep COVID in mind when preparing a menu for you on how the meal is served.

SEATING DURING SHOW: For this year due to Covid19 and trying to socially distance people we are going to be offering the visitor side to paying spectators as an option to sit on. We are aware that we have a small gym, and this is the reason for doing this option. That means we are not going to be allowing units back into the gym to watch. With that being said! We will monitor the situation and if no one takes the offer to sit on the other side we will open the visitor side back up to students to sit on. We are also going to try to have multiple TVs throughout the cafeteria, that way people can choose to watch live streamed from the cafeteria while they eat as well! For the performers we are going to try to have it live streamed to the Auditorium up on our big projection screen.

P.A. ANNOUNCEMENTS: Please type all announcements and have them ready when you check-in if they are different from your write up that you sent into KIDA. You may do your own announcing, or we will provide an announcer if you have the information to us before your performance. We request that any uncommon names be respelled phonetically, in parenthesis to assist our announcer with pronunciations. This is especially important when including the names of selections to be performed. ***You can get sound checks before the show, during the intermission after the first awards and the intermission between the gold and white guard portion of the show.***

AWARDS: Captains are to meet at the south side of the gym (***where you enter for competition***) before the awards ceremony. Please listen for an announcement, as we will call all captains. In lieu of trophies, we have elected to present a monetary award for all 1st, 2nd and 3rd place groups.

FIRST AID: A first aid station will be set up and manned by an EMT in the gym by the unit exit.

CRISIS COORDINATOR: On the day of the show there will be a crisis coordinator. This person is to take undue stress off our parent volunteers. If you run into any trouble in route to the school or once you get to our school, please contact the Crisis Coordinator. Jamie Reynolds will be the Crisis Coordinator with contact information below.

Sincerely,

Mr. Peter Vincenti

Director of Instrumental Music

Greencastle-Antrim High School

Brock Bricker - gamusicevents@gmail.com or 717-377-7016

Show Coordinator (If any questions before the day of the show)

Jamie Reynolds – 717-773-8956

Crisis Coordinator (For any issues the day of the show)

DIRECTIONS:

Address for the High School is 300 South Ridge Ave. Greencastle PA, 17225 (SPECTATORS ONLY, PLEASE ENTER BY THE ACCESS ROAD OFF OF LEITERSBURG ST.)

Address for the Middle School is 370 South Ridge Ave. Greencastle PA, 17225 (PERFORMERS ONLY- ALL BUSES AND EQUIPMENT TRUCKS)

Greencastle is located off Rt. 81 across the MD/PA border from Hagerstown, MD.

From the North, take Exit 5 of Rt. 81 South (Old Exit 3) and turn right at the bottom of the ramp onto Baltimore Street (Rt. 16 West). Follow Baltimore Street for approximately .4 or .5 miles. Look for the library on your left as you start down a small hill. Turn left at the Library onto Ridge Avenue and follow thru 2 stop signs. The schools are located on the left after the second stop sign. Continue to Middle School (next building). Drop-off and unloading will be in that area. **(See enclosed map).**

There is spectator parking in the rear of the High School. We will have parents to help direct the unloading as well.

From the South, take Exit 3 of Rt. 81 Rt. North (Old Exit 2) and turn left onto Rt. 11 North and follow for approximately 1 mile. Look for the World Kitchen on your left. You will need to bear right off Rt. 11 onto Washington Street (Fire Department on right side of Washington Street) and follow for approximately 3/4 of a mile. Turn right at the VFW onto Leitersburg Street and follow for 2 blocks. Take a left turn onto Ridge Avenue and then turn right into the Middle School. Drop-off and unloading will be in that area. **(See enclosed map).** **There is spectator parking in the rear of the high school. We will have parents to help direct the unloading as well.**

From the East (Waynesboro), take Rt. 16 West from Waynesboro to Greencastle. Follow Rt. 16 West though Shady Grove and continue to the first traffic light next to Sheetz. Turn left at the traffic light onto Grindstone Hill Road. Follow Grindstone Hill Road to a stop sign, turn right onto Leitersburg Street, and follow for close to a mile to Ridge Avenue (Middle School on right). Turn right onto Ridge Avenue and then right into the Middle School. Drop-off and unloading will be in that area. **(See enclosed map).** **There is spectator parking in the rear of the high school. We will have parents to help direct the unloading as well.**



SPECTATOR ENTRANCE



YOU WILL EXIT FROM THE GYM OUTSIDE TO LOAD EQUIPMENT. YOU WILL WANT TO MAKE SURE STUDENTS HAVE SHOES TO GO OUTSIDE TO TAKE EQUIPMENT OUT.

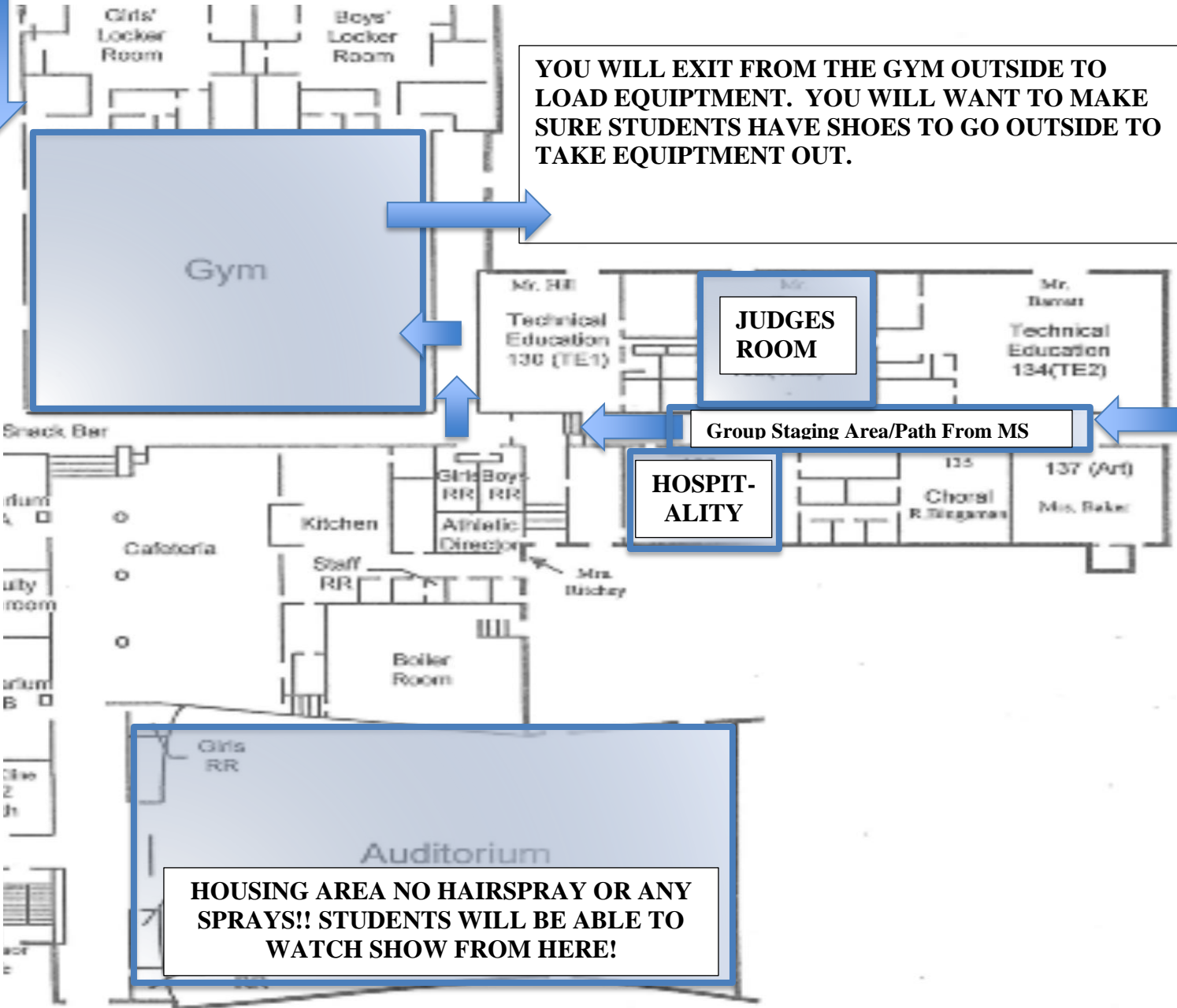

**REGISTRATION
ENTRANCE**



HOUSING AREA NO HAIRSPRAY OR ANY SPRAYS!! STUDENTS WILL BE ABLE TO WATCH SHOW FROM HERE!

HOSPITALITY

Group Staging Area/Path From MS

JUDGES ROOM

Gym

Girls' Locker Room

Boys' Locker Room

Mr. RR
Technical Education 130 (TE1)

Mr. Barrett
Technical Education 134 (TE2)

Kitchen

Cafeteria

Girls RR
Boys RR
Athletic Director

Boiler Room

Mrs. Hickey

135
Choral R. Singman

137 (Art)
Mrs. Baker

Girls RR

Auditorium

Sneak Bar

Dorm A

Utility room

Dorm B

Dorm C

Dorm D

Dorm E

Dorm F

Dorm G

Dorm H

Dorm I

Dorm J

Dorm K

Dorm L

Dorm M

Dorm N

Dorm O

Dorm P

Dorm Q

Dorm R

Dorm S

Dorm T

Dorm U

Dorm V

Dorm W

Dorm X

Dorm Y

Dorm Z

GA Middle School Warm-Up Areas

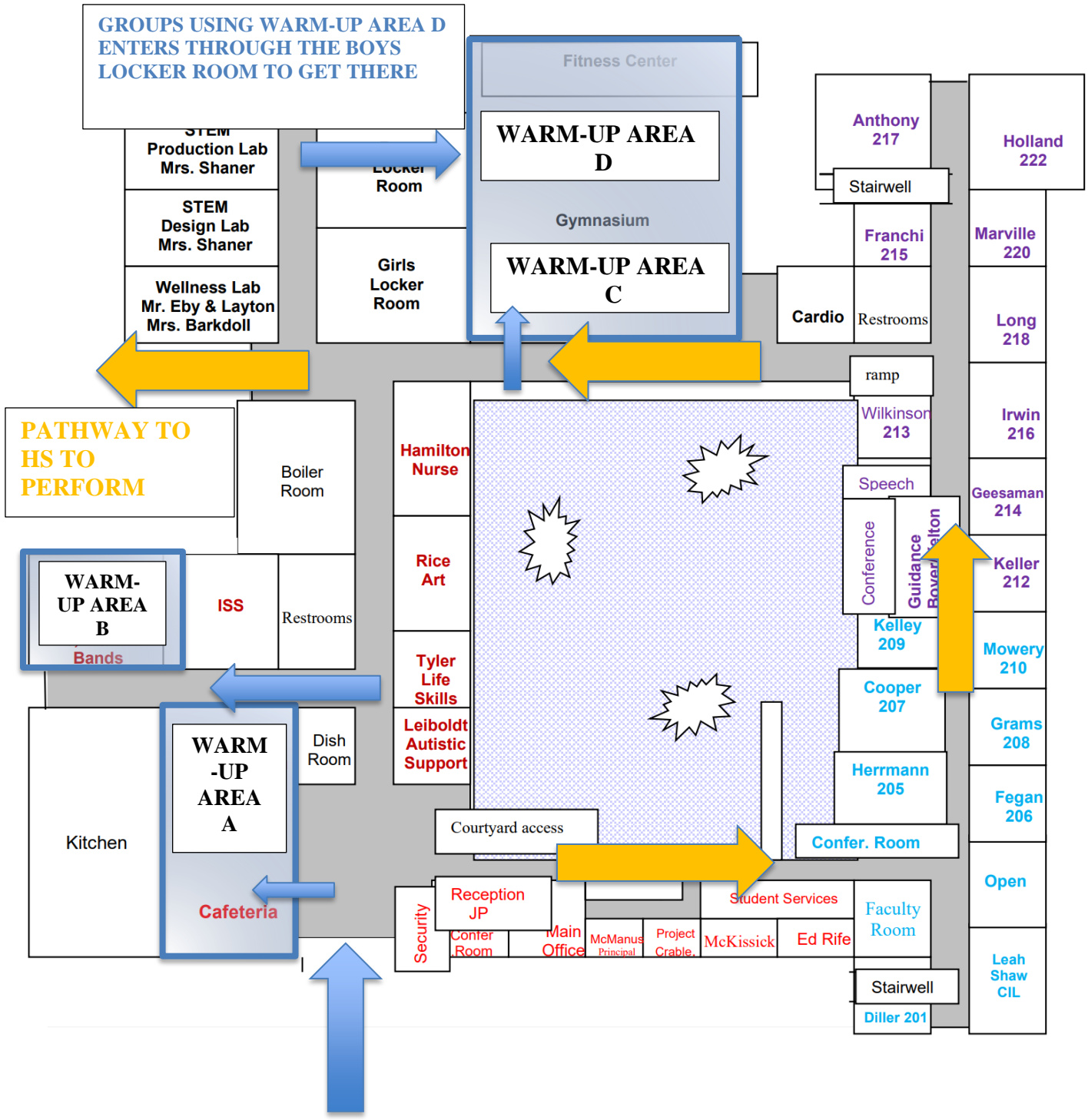

EQUIPMENT ENTERS THE SCHOOL HERE THE BLUE ARROWS WILL TAKE YOU INTO THE WARM-UP AREAS THE GOLD ARROWS WILL TAKE YOU TO THE HS TO PERFORM

FLOOR LOADING AND UNLOADING MAP

The floor will be divided in 1/2 horizontally.

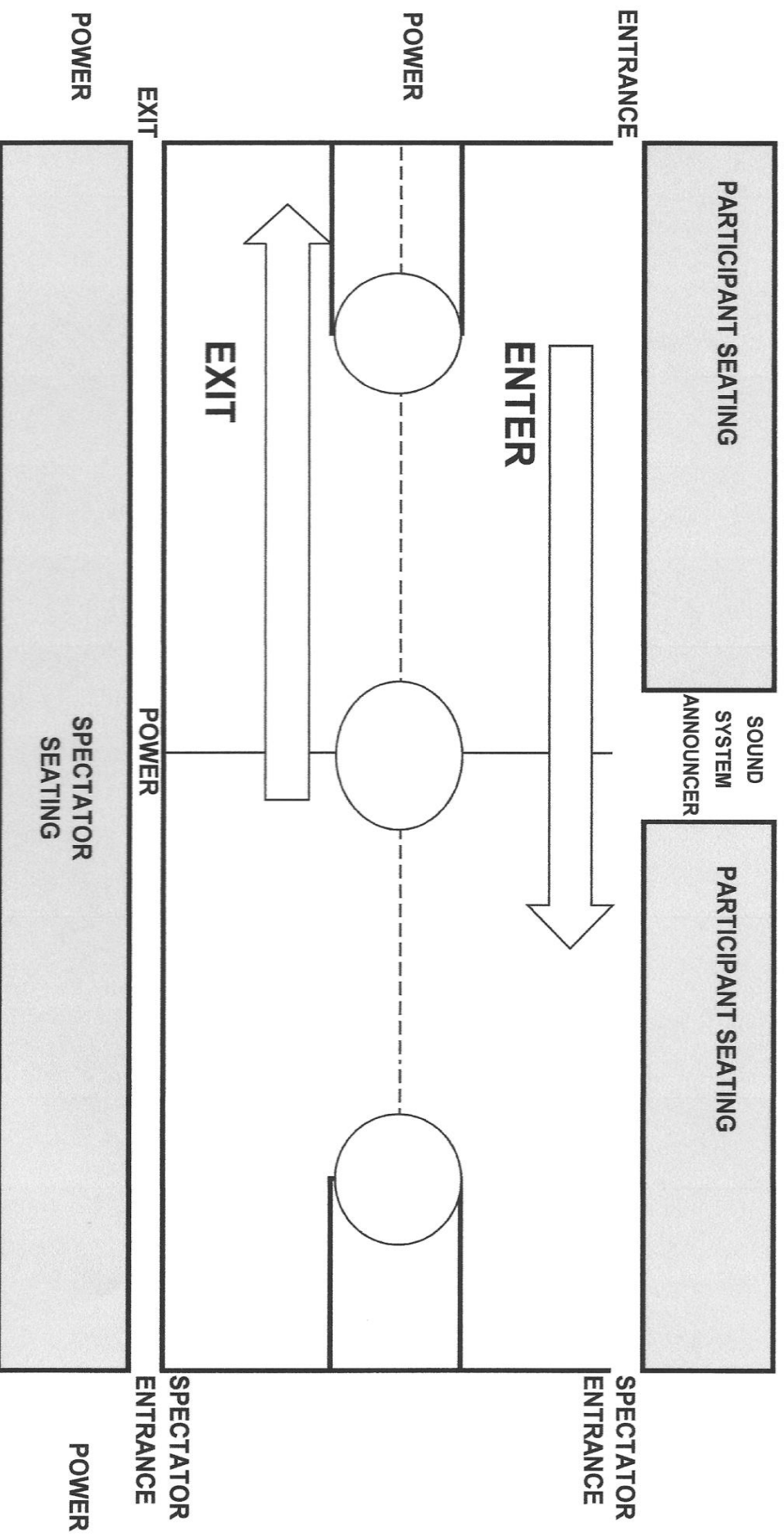

Since we are entering and exiting from the same side, the back to front entrance/exit rule will be in use. When the performance is over and the equipment is moved in front of the dotted line, the next unit will be able to start setting their equipment behind the dotted line. Once all of the equipment us removed from the front half of the floor, the signal will given to finish the set-up process. Remember that your floor time begins when you first cross the line and ends once all equipment/props are moved forward of the horizontal line. Also remember that after the equipment/props have crossed this line, they must continue to make forward progress out of the competition area.